

Ladder Portable Support Bracket

PRODUCT DESCRIPTION

Using three piece profiles plate construction, the slotted locking device allows on site adjustment providing both pitch and angle variation of the ladder support ensuring maximum stability and safety of the operator.

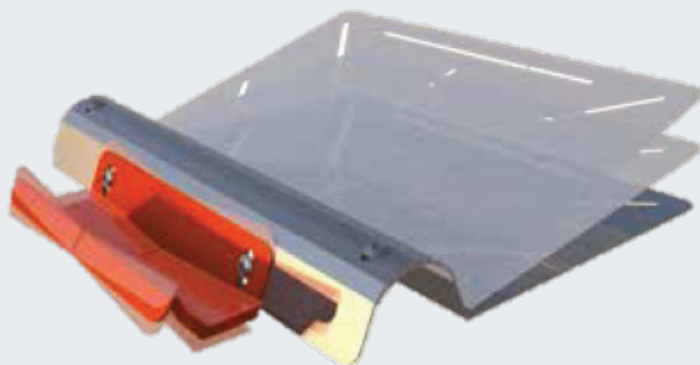

FEATURES / BENEFITS



STAINLESS STEEL

- Heavy duty industrial grade construction



LADDER ANGLE ADJUSTMENT

- Allows attachment to angled surface with rung support kept level



LADDER RUNG SUPPORT

- Easy visibility and ladder attachment

FIXING SLOTS

- Ensures easy location for attachment to structure



PITCH ADJUSTMENT

- Allows attachment to varying roof pitches



TIE OFF POINTS

- Provides additional facility to secure to ladder

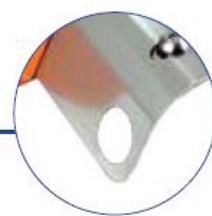

Ladder Support Bracket

Installation Procedure

LADDER BRACKET TO METAL DECK

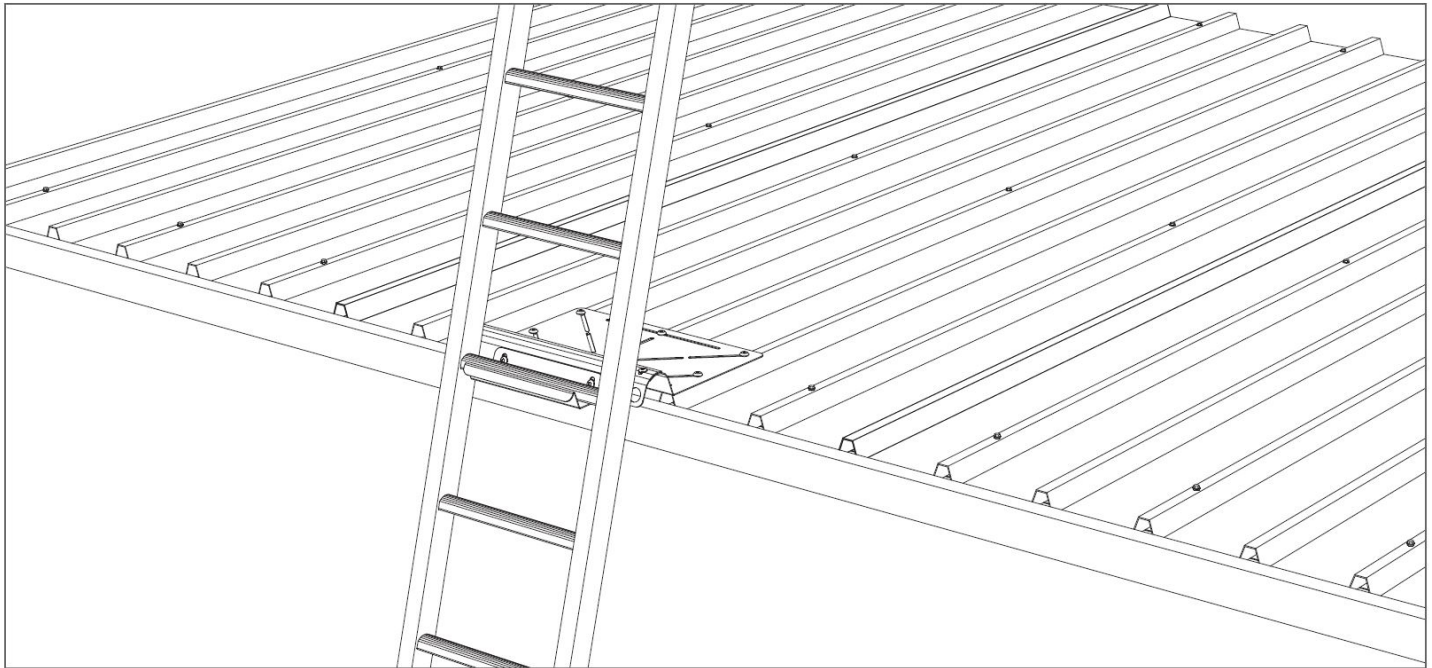

- Portable ladder to extend minimum 900mm above roof edge
- Ladder bracket to be positioned so that the ladder is resting on the ladder tie off flange and not the gutter or fascia

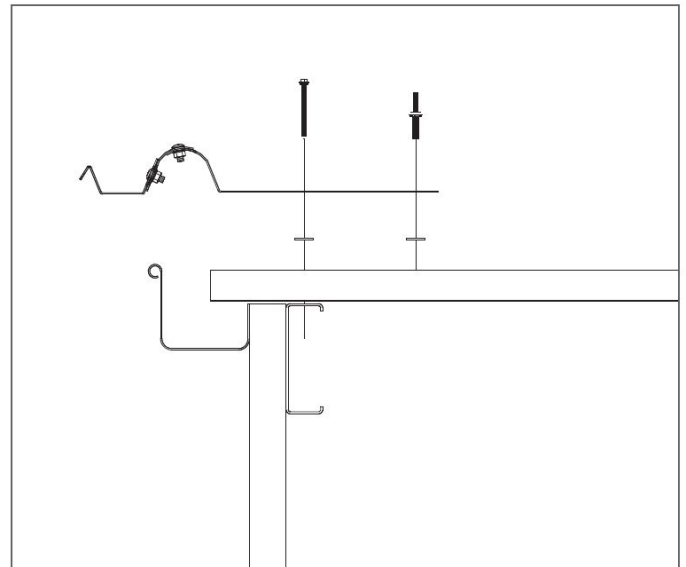
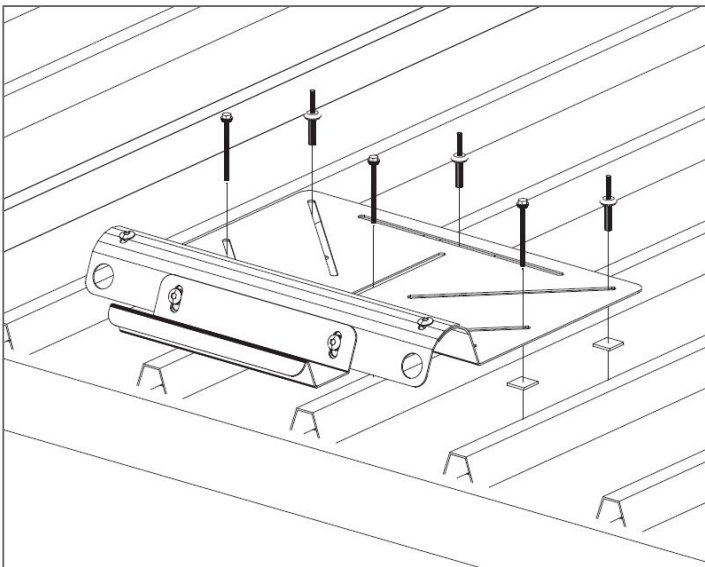

- Fix to roof deck using 6 fixings (combination of 14G tek screw and 8mm bulbtite rivets to suit the installation).

Ladder Support Bracket

Installation Procedure

LADDER BRACKET TO PARAPET

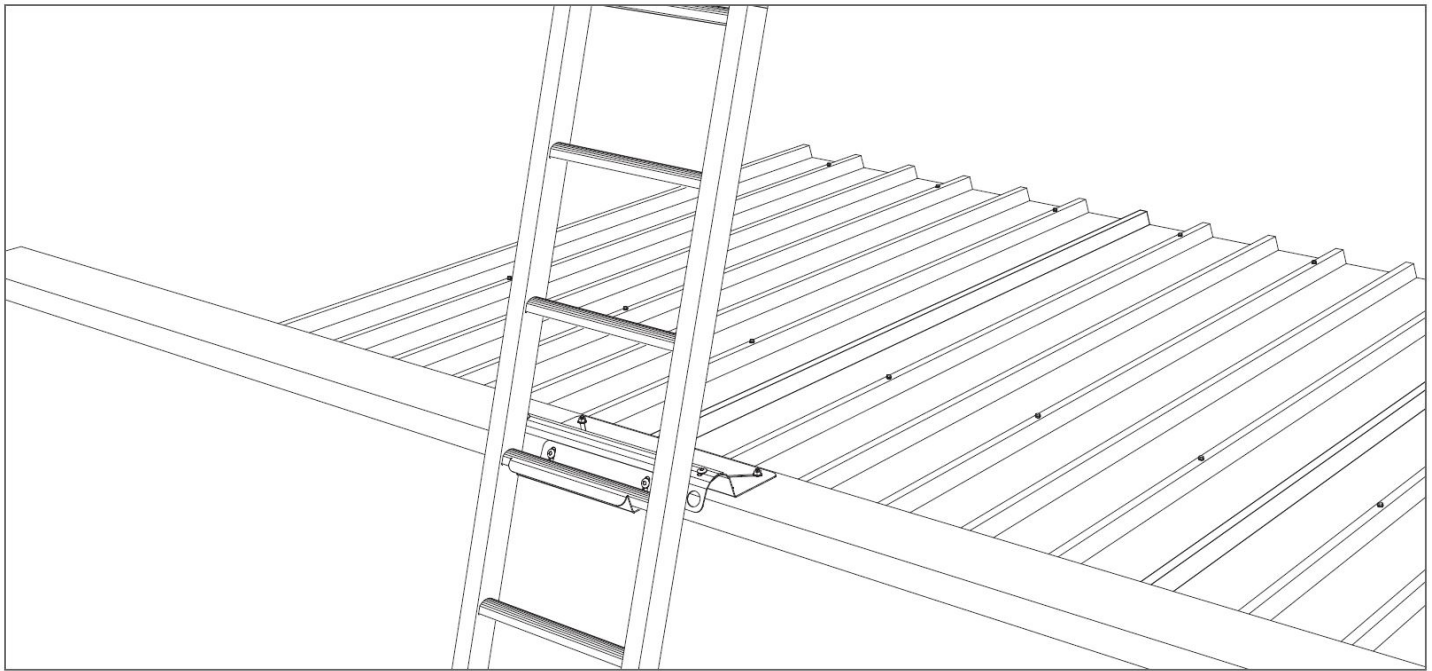

- Portable ladder to extend minimum 900mm above parapet edge
- Ladder bracket to be positioned so that the ladder is resting on the ladder tie off flange and not the parapet or fascia

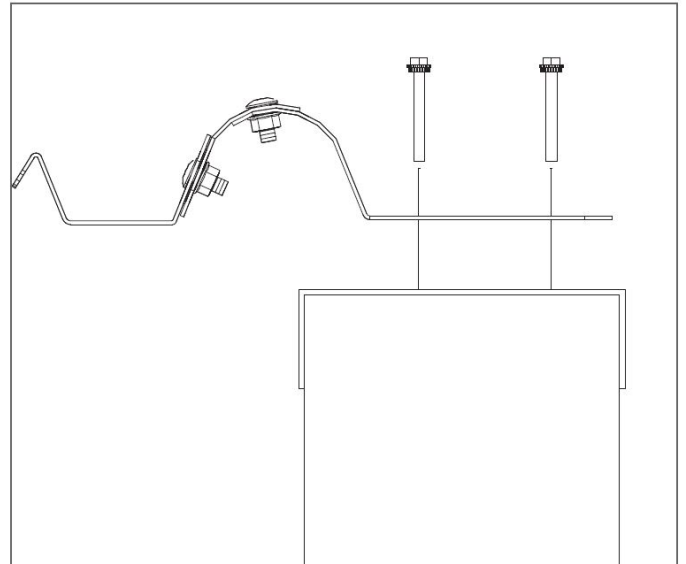
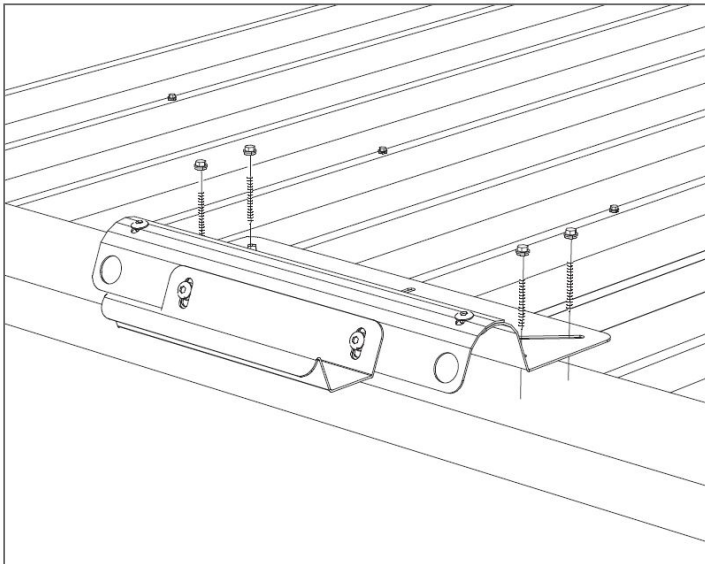

- Fix to concrete structure using minimum quantity 3, 8mm x 75mm screw bolt
- Fix to timber structure using minimum quantity 4, 4G x 75mm tek screw
- Fix to steel structure using minimum quantity 3, 8mm bolt set or 4, 14G x 75mm tek screw

Ladder Support Bracket

Installation Procedure

LADDER BRACKET TO WALL

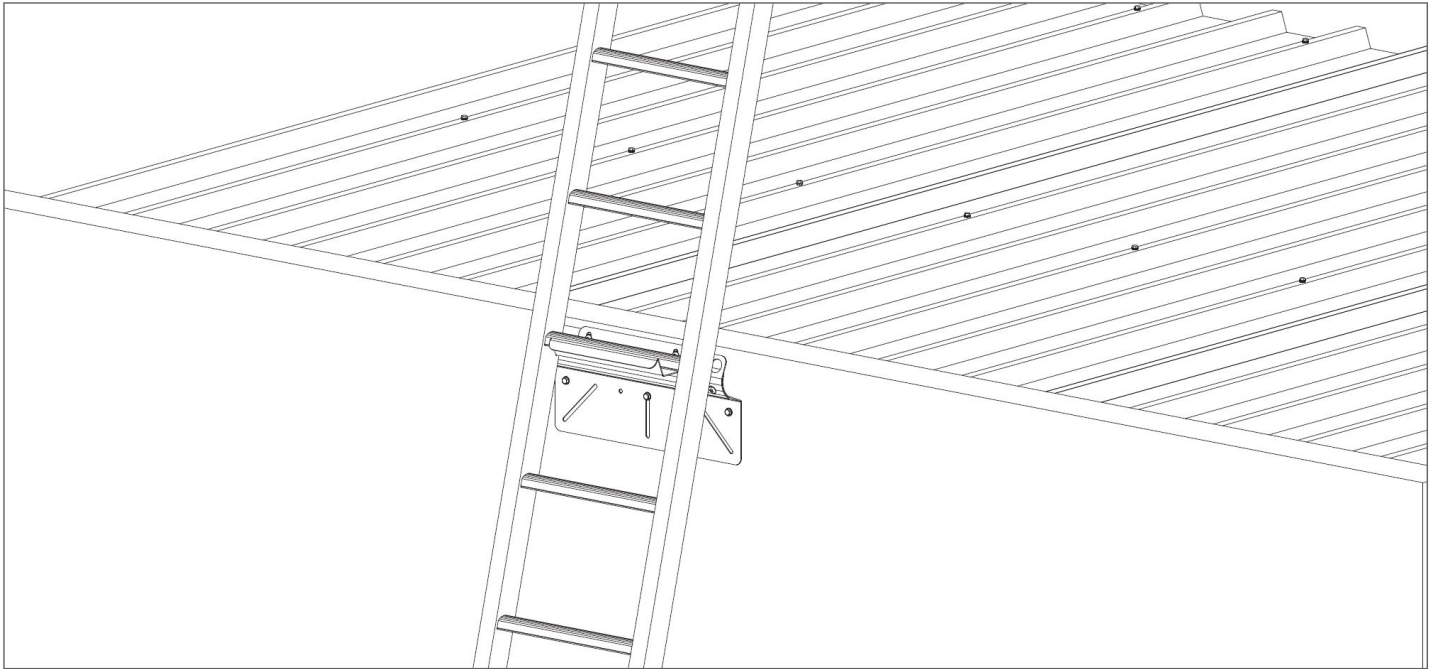

- Portable ladder to extend minimum 900mm above top of wall
- Ladder bracket to be positioned so that the ladder is resting on the ladder tie off flange and not the wall

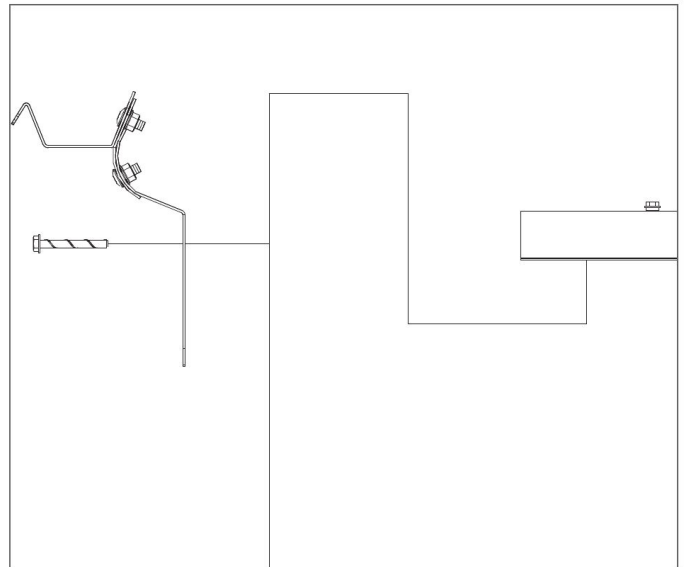
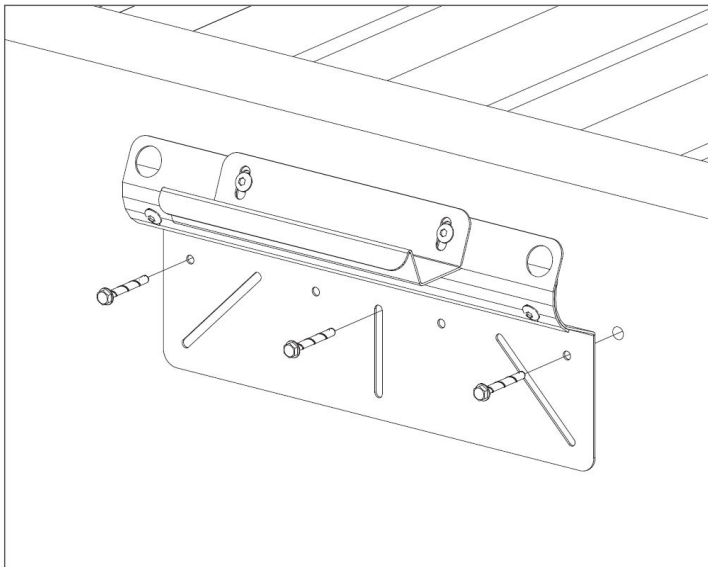

- Fix to concrete structure using minimum quantity 3, 8mm x 75mm screw bolt
- Fix to timber structure using minimum quantity 4, 4G x 75mm tek screw
- Fix to steel structure using minimum quantity 3, 8mm bolt set or 4, 14G x 75mm tek screw